

No	Part #	Description	Application	Qty	Price
				Req	Each
1	3H1810	Cover assy (X100)	1G prefix	1	119.79
	7H3106	Cover assy (X100)	2G prefix	1	119.79
	7H3211	Cover assy (X85)	1500	1	119.79
2	7H3008	Retainer	540	3	NCA
	7H3001	Retainer	560	3	6.00
3	7H3043	Release plate	-E11000	1	NCA
	7H3213	Release plate	E11001-	1	17.85
4	7H3214	Release bearing		1	51.13
5	7H3048	Retaining spring		2	2.85
6	7H3219	Clutch plate (X75)	540	1	90.75
	7H3215	Clutch plate (X50)	560	1	90.75

BEWARE OF CLUTCH JITTER! When installing a new clutch plate, always resurface the flywheel and fit a new cover assembly and release bearing.

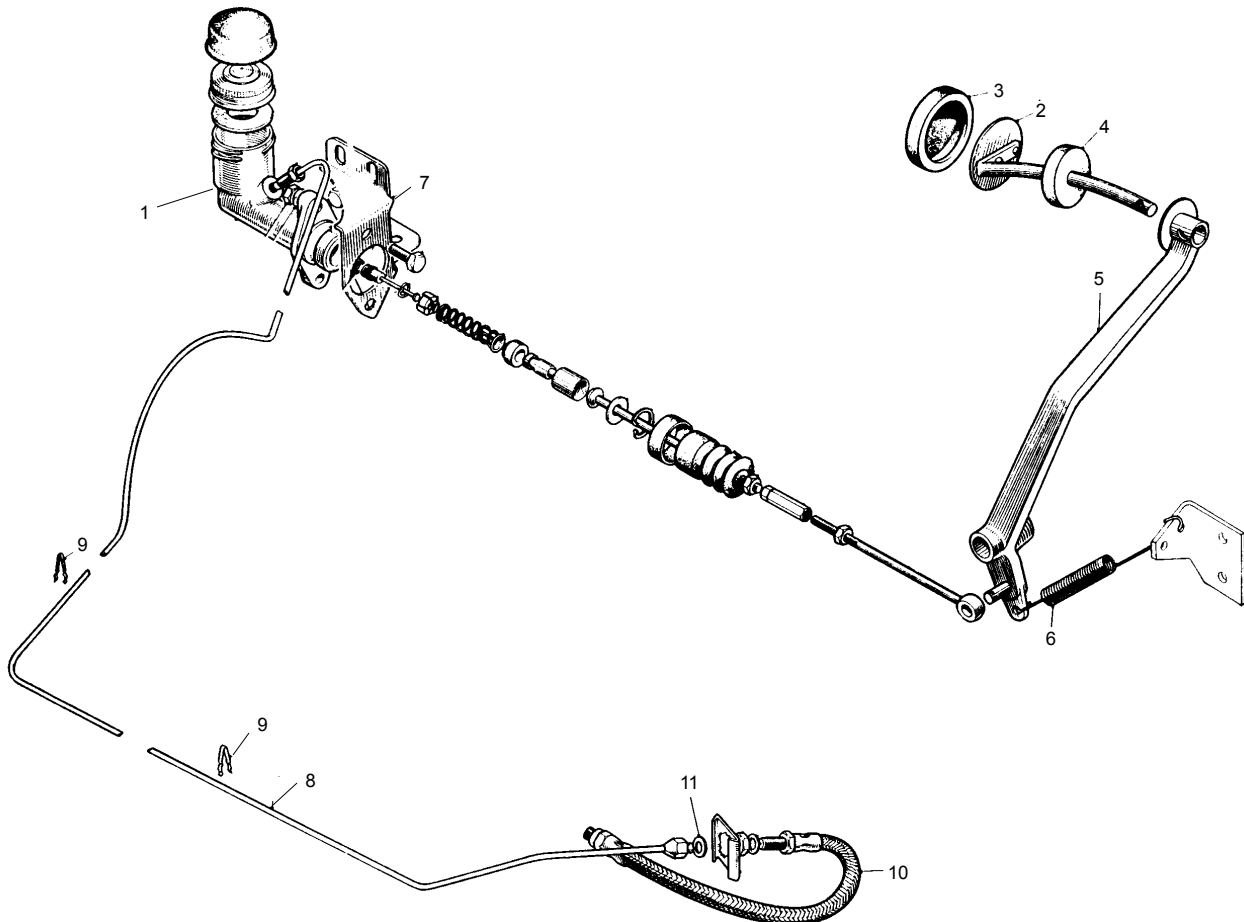

No	Part #	Description	Application	Qty	Price	No	Part #	Description	Application	Qty	Price
				Req	Each					Req	Each
1	2A5404	Master cylinder	E11001-	1	170.92	7	2A5324	Bracket (U)	E11001-	1	19.36
	8G2161	Repair kit, 5/8"	E11001-	1	23.90		8	11H48	Pipe	E59048-	1
2	2A5277	Clutch pedal (U)		1	10.89	9	6K35	Clip	E11001-	3	1.88
3	1G5028	Pedal cover		1	11.92	10	11B5086	Hose	E11001-	1	31.16
4	2A5209	Sealing cushion		1	3.45	11	3H2287	Washer, copper	E11001-	1	1.16
5	811 0516	Lever (U)	-E11000	1	16.94	Clutch slave cylinders are shown on page 14.					
	2A5316	Lever (U)	E11001-	1	16.94						
6	811 0521	Return spring-E11000	-E11000	1	NCA						
	2A5390	Return spring	E11001-	1	NCA						