

No	Part #	Description	Application	Qty	Price	No	Part #	Description	Application	Qty	Price
				Req	Each					Req	Each
	811 PK1	Panel kit	541	1	477.95	11	811 1349	Wheelhouse cover, left	540	1	57.48
	811 PK2	Panel kit	542	1	453.75		811 2212	Wheelhouse cover, left	560 no vent	1	54.45
	811 PK3	Panel kit	561 no vent	1	441.65		ALH2769	Wheelhouse cover, left	560 w/vent	1	54.45
	811 PK4	Panel kit	562 no vent	1	393.25	12	811 1346	Belt rail trim	541	1	37.82
	811 PK5	Panel kit	561 w/vent	1	441.65		811 2211	Belt rail trim	561 no vent	1	36.30
	811 PK6	Panel kit	562 w/vent	1	393.25		ALH2697	Belt rail trim	561 w/vent	1	36.30
NOTE: Panel kits include all interior panels, clips & screws required for one car.											
1	811 1337	Door panel, right	540	1	90.75	13	811 1343	Pillar trim, right	541	1	30.25
	811 2203	Door panel, right	560 no vent	1	81.07		811 2195	Pillar trim, right	561 no vent	1	29.04
	ALH2740	Door panel, right	560 w/vent	1	81.07		ALH2760	Pillar trim, right	561 w/vent	1	29.04
2	811 1336	Door panel, left	540	1	90.75	14	811 1342	Pillar trim, left	541	1	30.25
	811 2202	Door panel, left	560 no vent	1	81.07		811 2194	Pillar trim, left	561 no vent	1	29.04
	ALH2741	Door panel, left	560 w/vent	1	81.07		ALH2761	Pillar trim, left	561 w/vent	1	29.04
3	ALH1753	Clip		24	1.03	15	811 1351	Heelboard trim	540	1	32.67
4	811 1339	Quarter panel, right	542	1	50.82		811 2209	Heelboard trim	561 no vent	1	30.86
	811 2199	Quarter panel, right	562 no vent	1	45.98		ALH2766	Heelboard trim	561 w/vent	1	30.86
	ALH2748	Quarter panel, right	562 w/vent	1	45.98	16	811 1335	Cowl trim, right	540	1	32.67
5	811 1338	Quarter panel, left	542	1	50.82		811 2192	Cowl trim, right	560 no vent	1	30.25
	811 2198	Quarter panel, left	562 no vent	1	45.98		ALH2850	Cowl trim, right	560 w/vent	1	30.25
	ALH2749	Quarter panel, left	562 w/vent	1	45.98		811 1334	Cowl trim, left	540	1	32.67
6	811 1341	Quarter panel, right	541	1	45.98		811 2191	Cowl trim, left	560 no vent	1	30.25
	811 2201	Quarter panel, right	561 no vent	1	44.77		ALH2851	Cowl trim, left	560 w/vent	1	30.25
	ALH2750	Quarter panel, right	561 w/vent	1	44.77	17	ALH2674	Trunk lid trim	560 w/trunk lid	1	18.76
7	811 1340	Quarter panel, left	541	1	45.98	18	811 1157	Moulding	540	2	NCA
	811 2200	Quarter panel, left	561 no vent	1	44.77		811 2289	Moulding	560 no vent, right	1	NCA
	ALH2751	Quarter panel, left	561 w/vent	1	44.77		811 2288	Moulding	560 no vent, left	1	NCA
8	811 1348	Strainer trim, right	540	1	13.92		ALH2623	Moulding	560 w/vent	2	NCA
	811 2197	Strainer trim, right	560 no vent	1	13.31	19	ALH1803	Floor mat, front		1	95.59
	ALH2756	Strainer trim, right	560 w/vent	1	13.31	20	ALH1804	rear		1	43.87
9	811 1347	Strainer trim, left	540	1	13.92	21	ALH1806	right side		1	6.66
	811 2196	Strainer trim, left	560 no vent	1	13.31	22	ALH1807	left side		1	6.66
	ALH2757	Strainer trim, left	560 w/vent	1	13.31	23	ALH2700	trunk		1	44.17
10	811 1350	Wheelhouse cover, right	540	1	57.48	24	ALH1803A	Carpet set	front & rear	1	272.25
	811 2213	Wheelhouse cover, right	560 no vent	1	54.45		ALH1538	Door seal		2	12.05
	ALH2768	Wheelhouse cover, right	560 w/vent	1	54.45		122-8008	Super Weatherstrip Adhesive, 5 oz (black)		1	20.27
						25	811 1333	Stormstrip, beige	540	4	16.04
							439 1230	gray	560 no vent	4	16.04
							ALH2789	black	560 w/vent	4	16.04

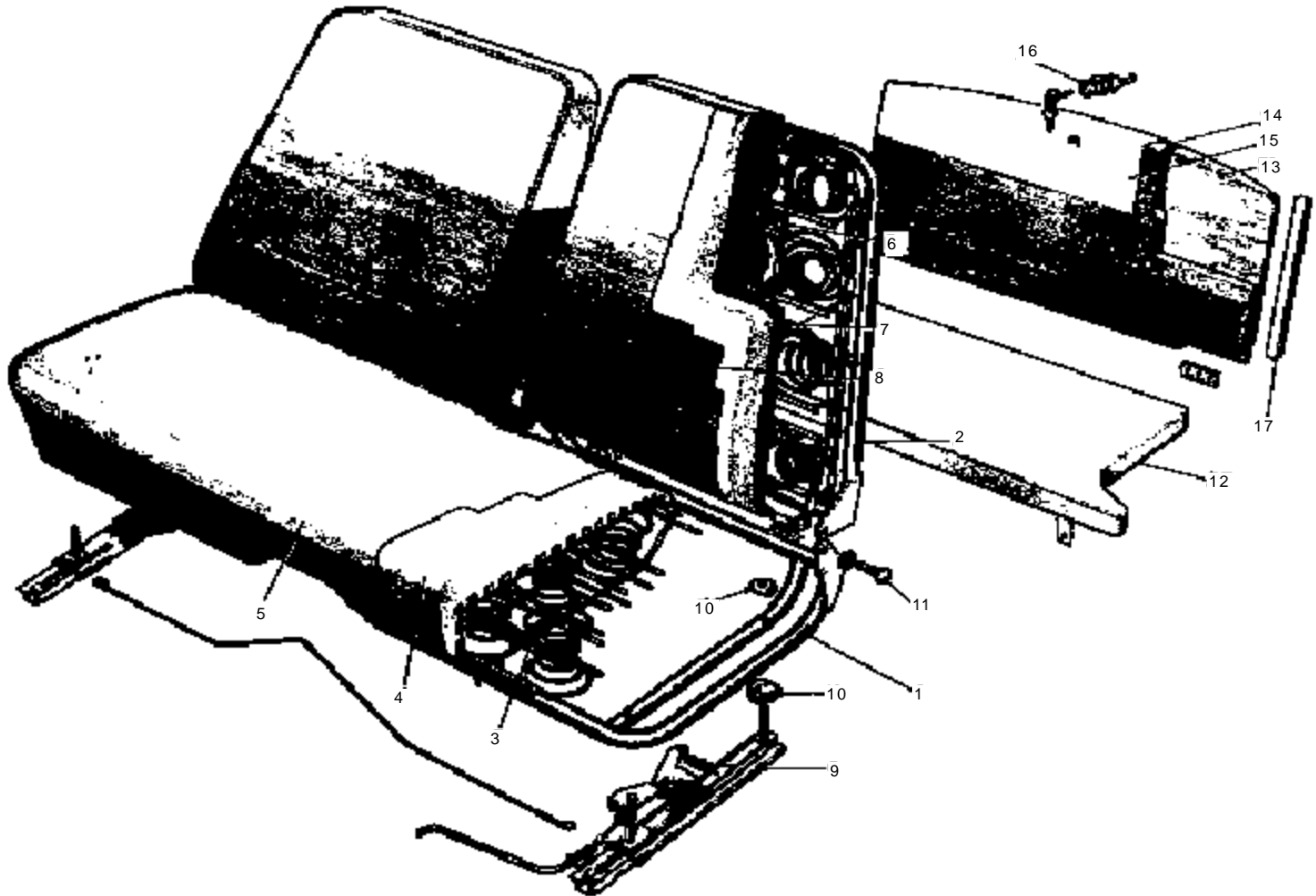

No	Part #	Description	Application	Qty Req	Price Each
	811 UK1	Upholstery kit	540	1	586.85
	811 UK2	Upholstery kit	560 no vent	1	526.35
	811 UK3	Upholstery kit	560 w/vent	1	526.35
NOTE: Upholstery kits contain front seat backs, front seat bottom, rear seat back, rear seat cushion & wheelhouse covers.					
1	811 0724	Bottom frame (U)	1 3/8" rise	1	42.35
	ALH2611	Bottom frame (U)	1 7/8" rise	1	42.35
2	811 0726	Right frame (U)	1 3/8" rise	1	22.99
	ALH2612	Right frame (U)	1 7/8" rise	1	22.99
	811 0725	Left frame (U)	1 3/8" rise	1	22.99
	ALH2613	Left frame (U)	1 7/8" rise	1	22.99
3	811 0672	Seat spring, bottom (U)	1 3/8" rise	1	75.02
	ALH2621	Seat spring, bottom (U)	1 7/8" rise	1	75.02
4	ALH1679	Padding		1	65.34
5	811 1354	Upholstery, bottom	540	1	180.29
	811 2206	Upholstery, bottom	560 no vent	1	164.56
	ALH2704	Upholstery, bottom	560 w/vent	1	164.56
6	811 0669	Seat spring, right (U)	1 3/8" rise	1	25.41
	ALH2618	Seat spring, right (U)	1 7/8" rise	1	25.41
	811 0668	Seat spring, left (U)	1 3/8" rise	1	25.41
	ALH2619	Seat spring, left (U)	1 7/8" rise	1	25.41
7	ALH2662	Padding, right or left		2	39.93
8	811 1353	Upholstery, right	540	1	125.84
	811 2205	Upholstery, right	560 no vent	1	107.69
	ALH2712	Upholstery, right	560 w/vent	1	107.69
	811 1352	Upholstery, left	540	1	125.84
	811 2204	Upholstery, left	560 no vent	1	107.69
	ALH2713	Upholstery, left	560 w/vent	1	107.69

No	Part #	Description	Application	Qty Req	Price Each
9	811 0666	Slide, right (U)	1 3/8" rise	1	114.95
	ALH2656	Slide, right (U)	1 7/8" rise	1	114.95
	811 0665	Slide, left (U)	1 3/8" rise	1	114.95
	ALH2657	Slide, left (U)	1 7/8" rise	1	114.95
10	ALG573	Seating washer (U)		8	6.36
11	ALH1671	Pin		2	48.35
12	811 1355	Rear cushion	540	1	125.84
	811 2208	Rear cushion	560 no vent	1	111.32
	ALH2724	Rear cushion	560 w/vent	1	111.32
13	ALH2616	Wood frame		1	88.33
14	ALH1728	Padding		1	19.36
15	811 1357	Upholstery	540	1	90.75
	811 2210	Upholstery	560 no vent	1	81.07
	ALH2733	Upholstery	560 w/vent	1	81.07
16	811 2334	Lock w/key		1	29.95
17	ALH1732	Strainer seal		2	3.94

High quality interior kits are manufactured by KMC with the correct stitching and materials for that original factory look and fit.

UPHOLSTERY SUPPLIES - Pig rings are used to attach the upholstery to the seat frame and are installed using special 'hog ring' pliers.

TL-HRP	Hog ring pliers	1	28.44
FN-PR	Pig rings, box	1	8.29
SB-CB-B	Seat belt, black w/chrome buckle 2		72.30